

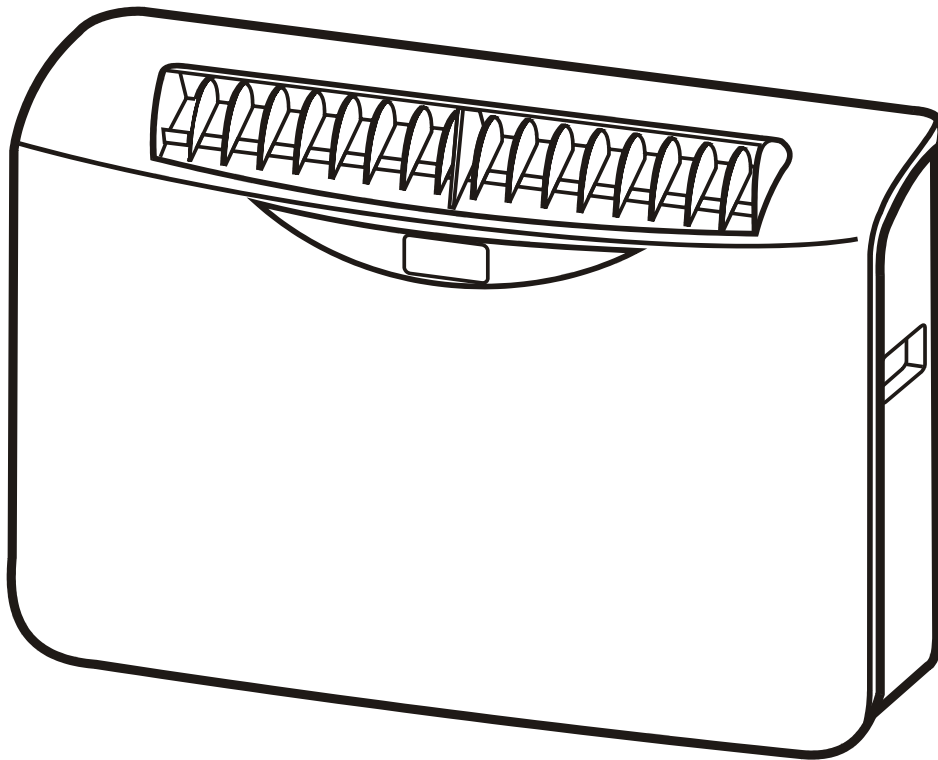

**8000BTU AIR CONDITONER
COOLING & HEATING
Model PMINISW8W / PMINISW8C**



**PLEASE READ THIS INSTRUCTION MANUAL
BEFORE OPERATING AND KEEP
SAFE FOR FUTURE REFERENCE**

CONTENT

Title	Page
A. Specification	3
B. Before use	4
C. Important safety instructions	5, 6
D. BS plug wiring	7
E. Product description	8, 9
F. Wall mounting installation instruction	10-14
G. Assembly instruction for mobile unit (only available in combi model)	15, 16
H. Operating instructions	17-21
I. Operation using remote controller	22, 23
J. Maintenance	24
K. Trouble shooting	25
L. Service & warranty	26

A. SPECIFICATION

Model		PMINISW8W PMINISW8C
Capacity(W)	Cooling Capacity	2300
	Heating Capacity	2400
Power	Cooling	920
	Heating	960
Dehumidifying Capacity (L/day)		25
Air Volume (m ³ /h)		320
Power Supply		220-240V ~ /50Hz
Noise Level (dB)		49
Refrigerant (g)		R407C / 400g
Net Weight(KG) (not includes accessories)		32
Dimension (H*W*D)	Body (mm)	465*765*235
	Package (mm)	536*930*315
<p>Notes:</p> <ol style="list-style-type: none"> 1. Cooling capacity is measured at ambient temperature Dry-bulb 27^oC, Wet-bulb 19^oC (Indoor and outdoor, the same). 2. Heating capacity is measured at ambient temperature Dry-bulb 20^oC, Wet-bulb 15^oC (Indoor and outdoor, the same). 		

B. BEFORE USE

- Transport & store the unit in an upright position only. Leave it in an upright position for at least 3 hours before first use.
- DO NOT dispose of any packaging until the installation of the air conditioner is completed.
- After having removed the packing, check that all the content is intact and complete. (See list of accessories). In the event of missing parts, contact your retailer.
- This air conditioner has been designed to cool or heat the air of a room and should only used for the purpose.
- The manufacturer cannot be held liable for damage caused to property or injury to persons or animals due to incorrect installation, regulation and maintenance or improper use.
- This air conditioner contains R407C refrigerant: at the end of its life, the disposal of this air conditioner must be in accordance with the strict regulation governing the recycling of this product, please operate with caution during the disposal. Please contact your local authority for regulatory advice.
- DO NOT switch on before having totally assembled the air conditioner and before installing in its correct operating position.

C. IMPORTANT SAFETY INSTRUCTIONS

- Always place the unit on an even, level surface.
- An opening in a window (in portable version only) or wall is required to accommodate the exhaust hose to expel the hot air.
- Ensure the unit is connected to an earthed power supply of the correct rating. (Refer to the rating label located at the back of the unit).
- The unit will cool when the room temperature is between 18°C~32°C depending on the thermostat setting.
- DO NOT use this unit for functions other than those described in this instruction manual.
- DO NOT tilt the unit.
- DO NOT cover or obstruct the appliance's inlet and outlet grilles.
- Your air conditioner has been designed to be used only in the home, office and similar conditions and should not be used for any other purpose.
- This unit is for indoor use only.
- Never unplug the air conditioner while it is working, this could damage the electronic circuits.
- DO NOT use the appliance in a wet room, such as a bathroom or laundry room to avoid the risk of electrical shocks.
- DO NOT bend or crush the warm air exhaust hose. (in portable version only)
- DO NOT sit or place articles on the appliance.
- DO NOT use the appliance with wet or damp hands.
- DO NOT let chemical substances come into contact with the appliance.
- DO NOT use the appliance in the presence of flammable substances or vapours such as alcohol, insecticides, petrol, etc.
- DO NOT use the plug to start and stop the appliance. ALWAYS use the intended control panel to start and stop the unit.
- ALWAYS turn off the appliance when it is not in use and remove the mains plug from the socket outlet.
- ALWAYS turn the unit off and remove the mains plug before cleaning, carrying out maintenance or moving location.
- Do not pull the electrical cable or place it near a source of heat: always unroll it completely to avoid dangerous overheating. If the power cord becomes damaged, the service agent or a similarly qualified person must replace it, in order to avoid a hazard.
- The filter must be used with the product at all times, when removing it for clearing always turn the unit off and unplug the mains plug from the socket.
- Do not operate the unit with a damaged power cord or plug, after it malfunctions, has been dropped or damaged. If the power cord is damaged it must be replaced by the manufacturer or a qualified service engineer to avoid a hazard.
- Closely supervise any children and pets when unit is in use



Energy Saving Tips

- Blocking of the filter reduces the efficiency of the air and increases its power consumption by up to 6%.
- Avoid opening doors frequently.
- Each person present in a room provides between 100 Watts and 150 Watts of heat. Consequently, the more people there are in a room, the less effective the unit will be in cooling.
- To ensure the optimal efficiency of the unit, we advise you to keep doors and windows closed, and to take into account the surface of the walls and windows exposed to the sun.
- Avoid the use of adapter plugs, multiple sockets and /or extension leads. If their use is necessary, ensure they conform to current safety standards.
- Before starting the appliance, check that it is correctly earthed, according to the legislation in force in the country concerned.

READ AND SAVE THESE INSTRUCTIONS



D. BS PLUG WIRING

Wiring Instructions: Should it be necessary to change the plug please note the wires in the mains lead are coloured in accordance with the following code:

BLUE - NEUTRAL
BROWN - LIVE
GREEN AND YELLOW - EARTH

As the colours of the wires in the mains lead of this appliance may not correspond with the coloured markings identifying the terminals in your plug, proceed as follows:

1. The **BLUE** wire is the **NEUTRAL** and must be connected to the terminal, which is marked with the letter **N** or coloured **BLACK**.
2. The **BROWN** wire is the **LIVE** and must be connected to the terminal, which is marked with the letter **L** or coloured **RED**.
3. The **GREEN/YELLOW** is the **EARTH** and must be connected to the terminal which is marked with the letter **E** or \oplus or coloured **GREEN OR GREEN/YELLOW**.
4. Always ensure that the cord grip is positioned and fastened correctly.

If a **13A (BS 1363)** fused plug is used it must be fitted with a **13A** fuse. If in doubt consult a qualified electrician.

Wiring for a 13 Amp Plug (BS1363)

Please note. The Earth Terminal is marked with the letter **E** or Earth Symbol \oplus

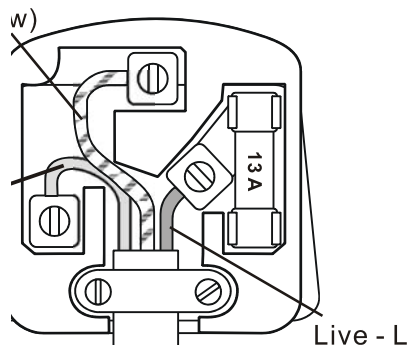

E. PRODUCT DESCRIPTION

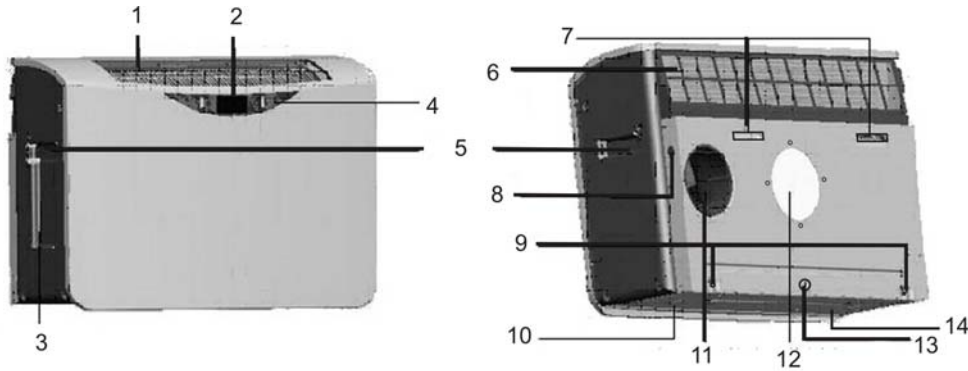

1.	Air outlet	8.	Wire control connection (optional)
2.	VFD display	9.	Caster bracket locking holes (using in mobile version only)
3.	Remote control storage	10.	Caster bracket hanging hole (using in mobile version only)
4.	Control panel	11.	Air exhaust
5.	Handles	12.	Air inlet
6.	Dust filter	13.	Drainage hole
7.	Hanging holes (for wall mount brackets)	14.	Caster bracket hanging hole (using in mobile version only)

Standard accessories

- A1. Remote control
- A2. Fix head with manual adjust louvre (Pre-installed)
- A3. User manual
- A4. Drain hose
- A5. Rubber plug

** Batteries not included

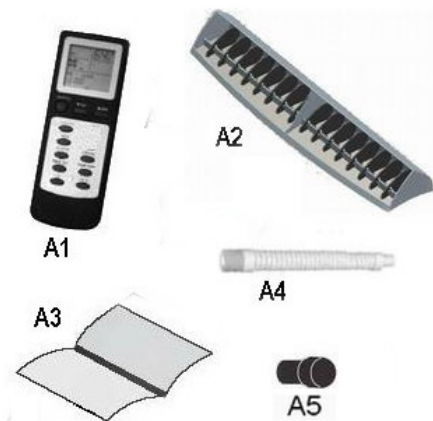

Wall mounted kit:

- W1. Wall bracket
- W2. Pipe flange
- W3. Air intake pipe (dia.120mm)
- W4. External grating
- W5. Hot air discharge pipe (dia.130mm)
- W6. Template for wall drilling
- W7. Extension condensate hose
- W8. Screw kit

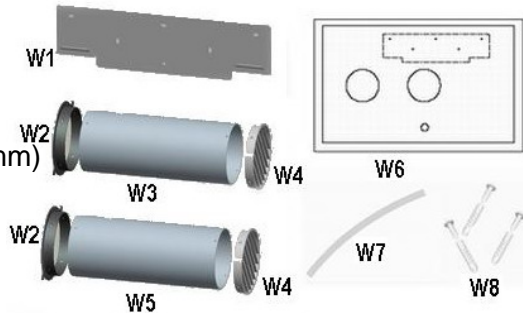

Mobile kit (optional):

- P1. Castors assembly
- P2. Metal grille
- P3. Unit flange
- P4. Air exhaust hose connector
- P5. Air exhaust hose
- P6. Adapter for window panel
- P7. Adjustable window panel
- P8. Butter-fly screw x 2
- P9. Screw x 4
- P10. Insulated sleeve

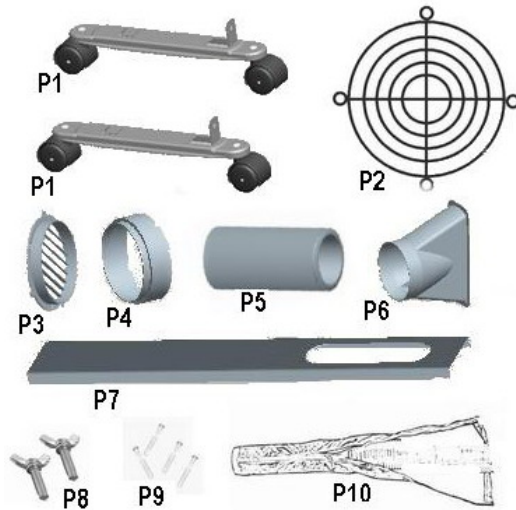

Schuko to UK converter plug

This Schuko to UK converter plug is used in this product. Refer to UK plug wiring instruction section for regular UK plug wiring.



F. WALL MOUNTING INSTALLATION INSTRUCTIONS

1. Positioning the air conditioner

- To obtain maximum performance from your unit, it must be correctly positioned. Please following the guidelines and instructions below in full, as failure to do so could cause potential installation problems:
- The air conditioner must be installed on an exterior wall that has access to the outside and a minimum of 2 meters free clearance to allow good airflow
- The unit must be fitted following the template, with space to the top, bottom and sides of the unit.
- The wall on which the unit is installed must be sturdy and able to withstand the weight of the unit.

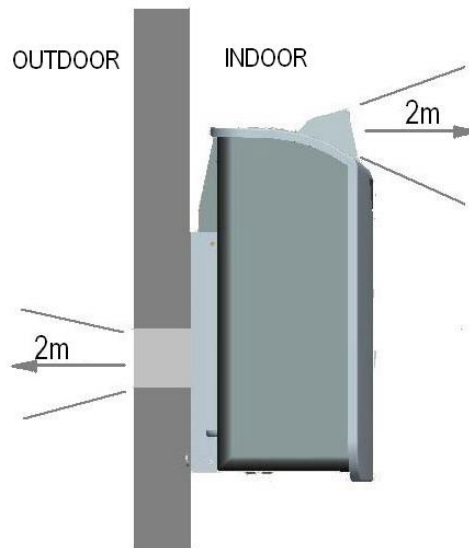

After determining the best place for installation as described above, please check to ensure that the wall can be drilled without causing damage to the fabric of the building. If necessary obtain professional advice to ensure that no damage is done to power supply or water pipes.

Please also ensure that there are no obstacles on the outside of the wall which may interfere with the performance of the unit.

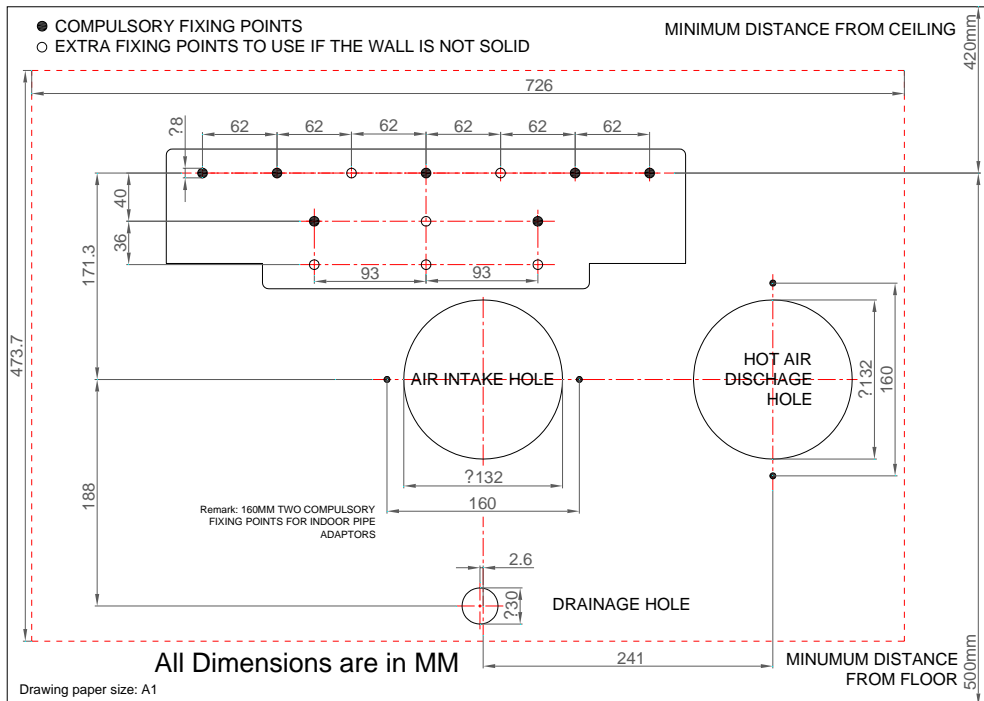

2. Template

Fasten the template to the wall once the following guidelines have been thoroughly checked.

- Do not drill any holes until you are 100% confident that there are no obstacles in the area you wish to drill and there are no obstructions, which could be hidden by the construction of the wall, for example: Electrical wiring, water & gas pipes or supporting lintels or beams.
- Ensure that a spirit level is used, as the unit must be level.
- Follow the installation instructions & measurements in full.

3. Drilling the Wall

Please note: If you are drilling the hole above ground floor level, please ensure that the outside area is supervised until drilling has been completed.

INTAKE AND OUTLET HOLES

- This operation should be carried out using the proper tools (diamond tip or core bit drills with high twisting torque and adjustable rotation speed)
- Fasten the template to the wall taking care to check the distance from the floor and or ceiling and keep horizontal by using a spirit level.
- Use a pilot drill to mark the centre of each core hole to be drilled. Use a core boring head having a diameter of 135mm to drill the two holes for intake and outlet air
- It is recommended that the holes must have a slight downward inclination of 3-5 degrees to prevent any backflow of water from the pipes.

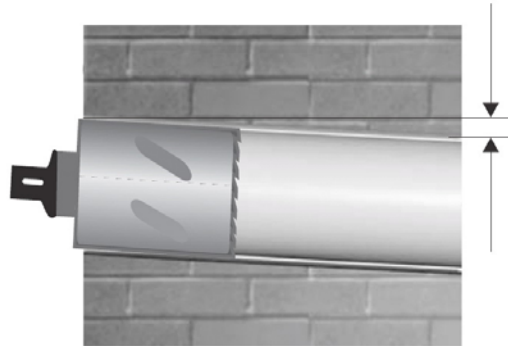

Drainage

The unit produces condensate that has to be extracted to enable the unit to operate correctly. It is necessary to drill a hole through the wall measuring 30mm in diameter in the position shown in the template. Drainage occurs by gravity. For this reason, it is essential for the drain line to have a minimum downward inclination of at least 3% throughout its length.

3. Fastening the bracket

- Drill the holes for anchoring the fastening bracket to the wall using the 6 holes showed in black on the template. If the wall is not sturdy enough it is advisable to use extra anchor bolts using the holes showed in grey on the template
- The anchor bolts provided require 8mm holes; the wall should be inspected to determine if provided bolts are sufficient. No liability can be accepted by the manufacturer or his agent in case of underestimation of the structural consistency of the anchorage made at the time of installation.



4. Installation of vent tubes

- After drilling the holes, the plastic pipes supplied with the air conditioner need to be fitted through them.
- The pipe with a diameter 130mm (hot air discharge) has to be fitted in the right hole. The length of the pipes should be matches to the thickness of the wall..
- Fit the plastic pipe into the hole and fasten the flange with 2* M4 screws on the wall. Please use the same instructions to fit the left hand tube (air intake pipe) using the supplied pipe with a diameter of 120mm.
- The tube diameter is slightly smaller than that carried out using the 135mm nominal diameter core drill. Please centre the pipe into the hole in the wall and insulate and seal using polyurethane foam to prevent air and humidity penetration.
- Fit the drainage pipe into the pre-drilled hole and seal as above. A further extension pipe can be fitted if necessary.

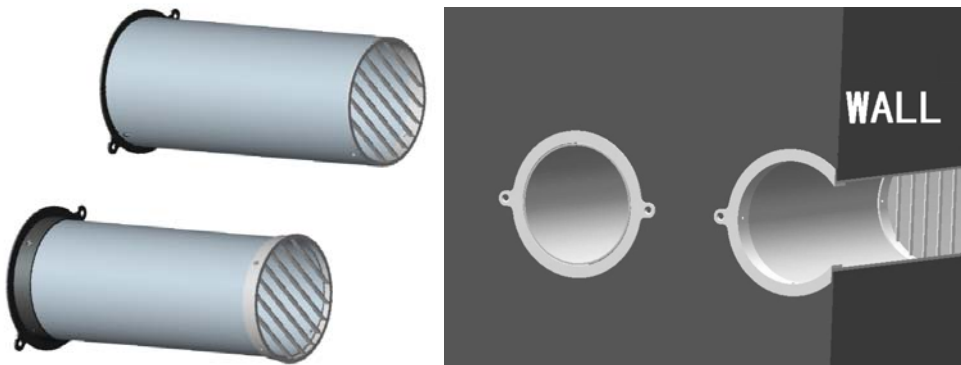

5. Remove the screws on the filter

Please remove the 2 screws before fastening the unit on the bracket.

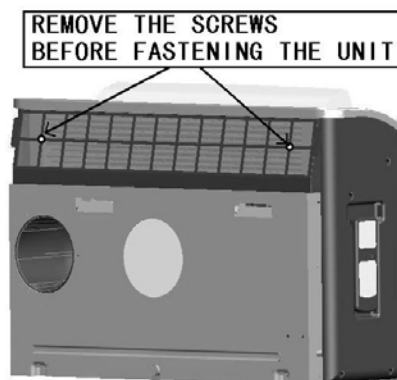

6. Fitting the unit on bracket

After checking again that the fastening bracket is securely fastened to the wall, and that any necessary preparations for electric connection and condensate drainage have been made, tilt the unit slightly towards you to aid the operation of fastening the unit onto the bracket. Fit the drainage pipe that protrudes from the back of the unit, which is then inserted in the drainage hole.

The air conditioner can now be pushed firmly against the wall. Carefully inspect the installation to ensure that the insulating back panel fits firmly against the wall and there are no gaps at the back of the air conditioner.

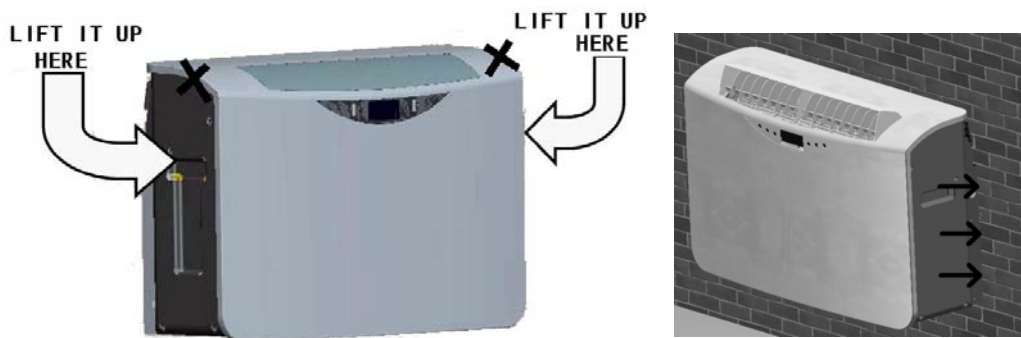

G. ASSEMBLY INSTRUCTION FOR MOBILE ONLY (only available in combi model)

If combi model is purchased, the mobile accessories are included.

1) Castors kit

- Two sets of castors system provided.
- Lift up the unit carefully. **DO NOT TURN THE UNIT UPSIDEDOWN**
- Fit the tongue of the Castor Frame in the square hole on the bottom of the base plate.
- Screw the castor frame on the back panel of the unit with the butter fly screw.

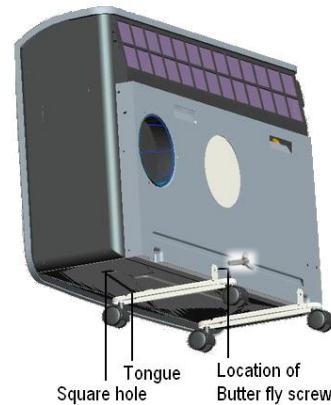

2) Window Kits

Note: Your window kit has been designed to fit most standard vertical and horizontal window applications. However, it may be necessary for you to improvise/modify some aspects of the installation procedures for certain types of windows. Please refer to measurements:

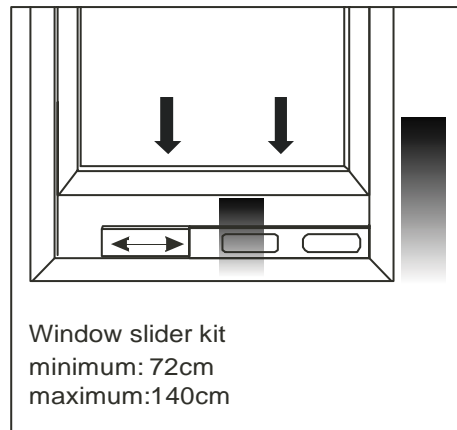
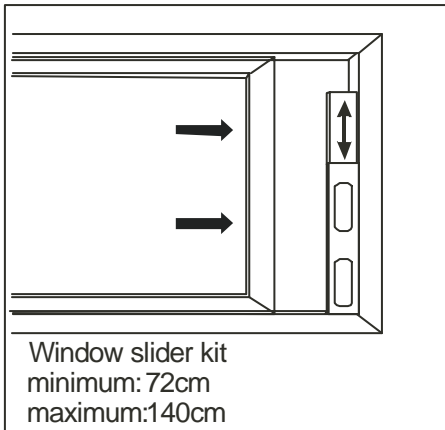

3) Hose and grille

- Screw the Metal Grille (P2) to cover the right hole on the back of the unit.
- Screw the Unit Flange (P3) to cover the left hole on the back of the unit.
- Select a suitable location; make sure you have easy access to an electrical socket.
- Remove the hose, window exhaust adapter, and window panel kit.
- To install the flexible hoses, insert the end of the hose with the round connector, turn the connector clockwise on the Unit Flange.
- Screw the window exhaust adapters on hoses by turning them clockwise.
- Insert the air outlet window exhaust adapter into the hole of the window panel kit.

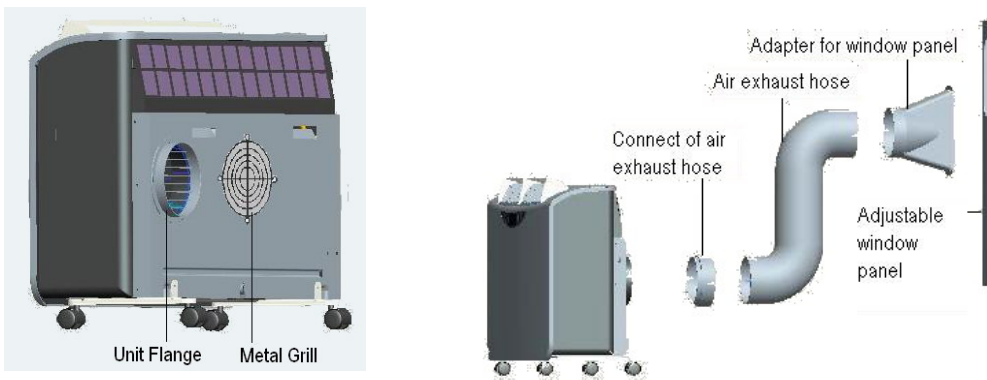

4) Filter screws

Please fasten filter screws if it is removed in wall installation. Always fasten the filter in portable.
Only remove it in cleaning.

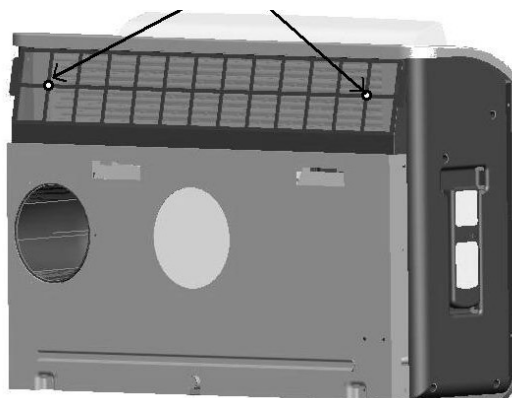

H. OPERATION INSTRUCTIONS





CONTROL PANEL

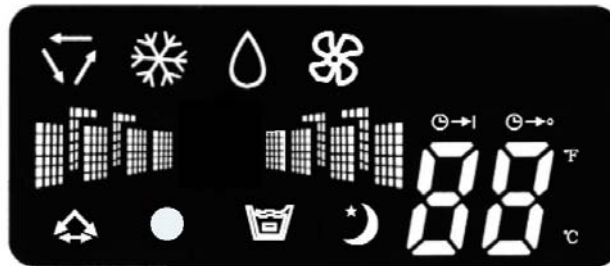

VFD DISPLAY



Control Panel Functions

- 1) **On/Off**
Starts or Stops the Unit
- 2) **Mode**
Select the functions of the unit for:
 - Auto Mode 
 - Cooling Mode 
 - Dehumidifying Mode 
 - Fan Mode 
 - Heating Mode 

3) **Fan Speed Control** 

Select the fan speed for:

High / Medium / Low

The fan speed can be visually distinguished by the speed of the digital air segments progressing out from the windmill fan image on the VFD display.

4) **Temperature**

Select the desired temperature by pressing either “**UP**” or “**DOWN**” button when using the unit in cooling or heating function. The VFD flashes to display the desired temperature during setting, it displays the room temperature after 5 seconds.

5) **TIMER**

Press “**TIMER**” button until the VFD display shows a flashing “→|” to set Automatic Off time while the unit is running.

Press “Timer” button and the VFD display will show a flashing “→°” to set Automatic On time while the unit is in ready state.

Press either “**UP**” or “**DOWN**” buttons to set the clock to the required turn off time or turn on for 1 hour by pressing once. The adjustable time range is 1 hour to 12 hours.

The light will flash for 3 seconds to activate the timer which has been programmed programmed.

Press the **TIMER** button again to cancel the setting.

OPERATION USING CONTROL PANEL

1) Cooling Operation

- a) If using in mobile mode, ensure that the exhaust duct is correctly installed.
- b) Plug the Power Cord in to the power outlet socket
- c) Turn on the unit by pressing the **ON/OFF** Button on the control panel.
- d) Press **MODE** Button until “❄️” appears on the VFD display
- e) Press **UP** or **DOWN**... until the desired room temperature appears on the VFD. The temperature ranges from 16 °C-31°C.
- f) Select desired fan speed by pressing the **FAN** Button.

NOTE: During hot days, the unit will cool off the room most efficiently by setting the temperature at the lowest and the fan speed at the highest. Reducing the length of the exhaust duct and insulating the exhaust duct and keeping direct sunlight to a minimum will also improve the cooling efficiency.

2) Dehumidifying Operation

- a) If using in mobile mode ensure that the exhaust duct is correctly installed.
- b) Plug the Power Cord into the power outlet socket.
- c) Turn on the unit by pressing the **ON/OFF** Button on the control panel.
- d) Press the **MODE** Button until the “💧” appears on the VFD display.

NOTE: The unit operates at low fan speed during dehumidifying. The unit cools room slightly during dehumidification. Keep the windows and the doors closed to aid the effectiveness of the unit in removing moisture from the room. The unit will not perform dehumidification when the room temperature is lower than 61°C.

3) Fan Operation

- a) Plug the Power Cord into the power outlet socket.
- b) Turn on the unit by pressing the **ON/OFF** Button on the control panel.
- c) Press the **MODE** Button until “” appears on the VFD display.
- d) Select the fan speed by pressing the **FAN** Button.

NOTE: When the unit is running in fan mode, the exhaust duct is inoperative and is not required.

4) Heating Operation

- a) Plug the Power Cord into the power outlet socket.
- b) Turn on the unit by pressing the **ON/OFF** Button on the control panel.
- c) Press the **MODE** Button until “” appears on the VFD display.
- d) Press the button **UP** or **DOWN** until the desired room temperature appears on the VFD. The temperature ranges from 16°C-31°C.
- e) Select the fan speed by pressing the Fan button. It is recommended to use the low fan

NOTE: When activating the heat pump, the unit will shut off for 3-5 minutes before starting the heating operation.

For the portable type, when the unit is running on heating mode, stretch out the air exhaust hose to their full length, and wrap the insulated sleeve around the hose and secure with the Velcro. Do this before installing the exhaust hose into the air outlet ports on the back of the unit.

5) Auto Operation.

- a) Turn on the unit by pressing the **ON/OFF** Button on the control panel.
- b) Press the **MODE** Button until the “” appears on the VFD display.
- c) Select the fan speed by using **FAN** button.

During **AUTO** mode, the unit operates at heating mode when the room temperature is below 20°C. It operates at dehumidifying mode when the room temperature is between 20°C to 26.6°C. It operates in cooling mode when the room temperature is above 26.6°C. You may use the timer with the AUTO mode.

6) **Sleep Mode** (This Mode is available when using Remote control)

- a) The air conditioner is in operation
- b) Press **SLEEP** Button, the “☾” appears on the VFD.
- c) The fan motor of indoor unit runs in low speed
- d) When in cooling mode, during the first two hours, the temperature will be increased 1°C per hour. The unit will then operate at 2°C higher than the originally set figure for 6 hours. The temperature will then return to the originally set figure
- e) When in heating mode, during the first 2 hours, temperature will be decreased 1°C per hour. Then temperature will be keeping at 2°C Lower than the original set figure for 6 hours. The temperature will then return to the originally set figure.
- g) When in dehumidify mode, the temperature will not be changed.

NOTE

In exceptional conditions of low temperature and high humidity, condensate may accumulate at a rate faster than it can be discharged. The symbol ‘’ will appear in the control panel. In order to restart the unit it is advised that the ‘drain port’ is utilized. You should use a container of at least 1.5ltr capacity to collect the condensate. This normally applies when used in mobile mode.

I. OPERATION USING REMOTE CONTROLLER

1. Remove the cover from the back of the remote control.
2. Insert two AAA dry-cell batteries (batteries included).
3. Insert the power plug into an outlet.
4. Always point the remote control signal transmitter toward the unit when operating.
5. Make sure that the signal path is not obstructed.
6. The maximum distance at which signals can be received is 8M.
7. Remove the batteries if the unit is not going to be used for an extended period of time.

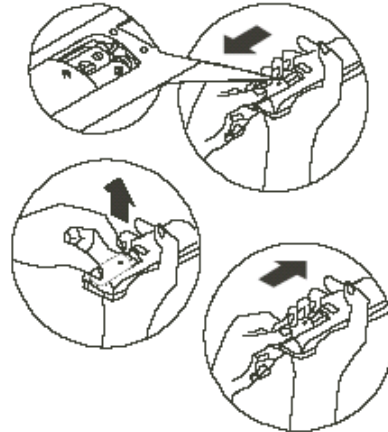

A CHANGE IN THE FUNCTION IS USUALLY INDICATED BY A BEEP.

8. DO not abuse the remote control
9. Do not place the remote control in a location that is exposed to direct sunlight or next to a heating unit or other heat source.
10. Do not use rechargeable batteries because they differ from standard dry cell batteries in shape, dimension and performance.
11. Be sure to replace the batteries with two new batteries of the same type.

IMPORTANT: At the end of their life dispose of the batteries according to Local Authority regulations. Do not dispose of batteries with your normal household rubbish.

Remote control real time clock instructions

1. Open the battery cover of the remote control and press the **CLOCK** button with a pencil or pen.
2. Press the HR. button and MIN button and adjust the correct time.
3. Press the CLOCK set button again and close the batter cover.
4. The display will show the correct time.

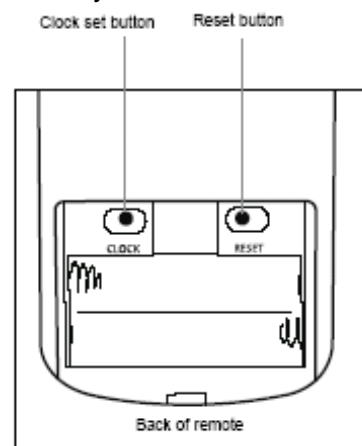

5. Clock Time settings: HR and MIN

To set the hours, press HR button once, the time will add 1 hour, continue to press this button, the clock will add by 1 hour until extended 11 hours, then will change to PM or AM and return to 0(12:00).

To set the minutes, press MIN button once, the clock will add 1 minute, continue to press this button and the clock will add by 1 minute until extended to 59 minutes, the return 00.

TO RESET ALL FUNCTIONS ON THE REMOTE CONTROL PRESS THE RESET BUTTON WITH A PENCIL OR PEN.

REMOTE CONTROL FUNCTIONS

1. ON/OFF –Starts or Stops the Unit.
2. WARMER- Adjust to desired warm temperature.
3. COOLER – Adjust to desired cool temperature.
4. MODE – Select the functions of the unit for: Auto Mode, Cooling Mode, Dehumidifying Mode, Fan Mode and Heating Mode.

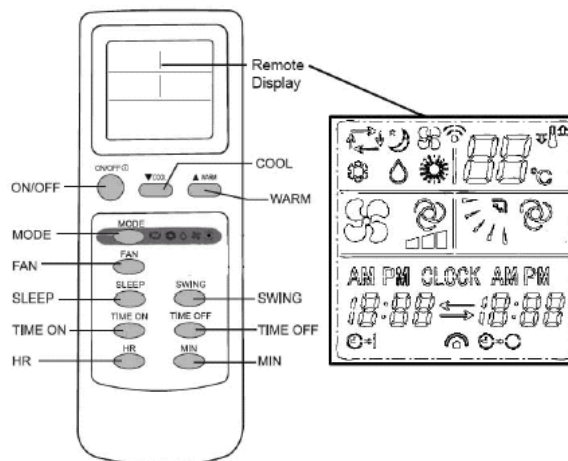

5. FAN – Select the fan speed desired: High, Medium and Low
6. SLEEP–To set the unit for sleep mode.
7. SWING – To start swinging air louvers vertically by press SWING button once. To stop, press the SWING button again. Horizontal air flow direction can be adjusted manually.
8. TIME ON – To program the timer, press TIME ON button until the VFD display shows a flashing ⌚→|, to set automatic ON time while the unit is ready.
9. TIME OFF – Press TIMER OFF button and the VFD display will show a flashing ⌚→°, to set automatic OFF time while the unit is running.
10. HR–Press to set the desired hour setting.
11. MIN–Press to set the desired minute setting.

NOTE: ALL SETTINGS CAN BE VIEWED ON THE REMOTE DISPLAY

J. MAINTENANCE

Note: Make sure power is off and the plug is pulled out of the power outlet before performing any maintenance activities.

1) Clean or replace filter

If the air filter is blocked with dust, the airflow volume will reduce. It is recommended that the filter be cleaned at least once every two weeks.

a) Pull up the filter from the filter compartment in the back of the unit.

**For portable unit, please remove the 2 screws on the filter first before remove filter to clean.

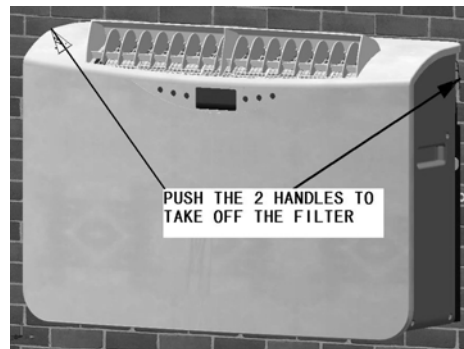
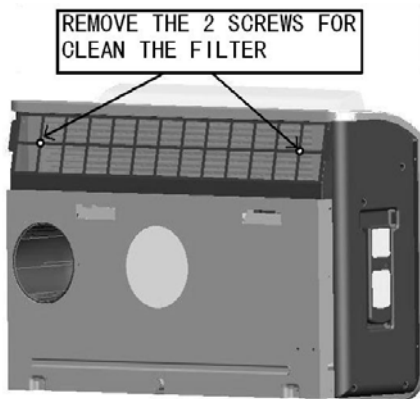

b) Wash the air filter by immersing it gently into warm (about 40°C) water with a neutral detergent. Rinse the filter and dry it thoroughly in a shaded place.

c) Replace the filter back into the filter compartment after it is thoroughly dried.

d) If the filter is damaged or unusable, order a new filter by calling your local service agent or supplier.

2) Case

a. Keep the unit from being exposed directly to the sun to prevent colour fading.

b. Clean the surface with a damp cloth. Dry it with a soft towel.

3) Storing the Unit for an Extended Period of Time or Transporting

a. Empty water by unplugging the water drainage stop at the back towards the bottom of the unit

b. Unplug the unit.

c. The unit should be stored in a cool dry place.

K. TROUBLE SHOOTING

Please check the following items before asking for repairing:

PROBLEMS	CAUSES	SUGGEST SOLUTIONS
The unit does not work	Power supply fault: 1. Not plugged in; 2. Faulty plug or socket; 3. Fuse broken	1. Plug in correctly; 2. Change the plug or socket; 3. Replace fuse
The unit stops running automatically	Timer is set or room temperature is lower than set temperature.	Close the timer or reset temp.
In cooling mode, no cooling air coming out	1. Room temperature is lower than set temperature. 2. There is frost on the surface of evaporator.	1. This is normal. 2. The unit is defrosting and it will run when the defrosting is finished.
The remote control does not work	1. Exhausted batteries 2. Batteries incorrectly installed.	1. Change the batteries. 2. Re-install the batteries correctly
The unit does not work for 3 minutes when switched on.	Protection of the unit.	Wait for approx.3 minutes and the unit will start.
Error code "E2" in VFD display	Failure of the indoor sensor.	Change the indoor temperature sensor
Error code "E3" in VFD display	Protection of cooling mode	
Error code "E4" in VFD display	Failure of the indoor coil sensor.	Change the indoor coil sensor
Error code "E5" in VFD display	Failure of the upper fan motor	
Error code "E6" in VFD display	Failure of the system	Check if the refrigerant leaking or missing.
Error code "E7" in VFD display	Protection of heating mode	

Error codes are for information only. Advise your local service agent as appropriate.

L. SERVICE & WARRANTY

- Do not operate the unit with a damaged cord or plug, after the unit malfunctions, or has been dropped or damaged.
- For your convenience, record the complete model number and product name (located on the Product Identification Plate), the date you purchased the product, and attach your purchase receipt docket as proof of purchase. To ensure your product is covered by warranty, the complete faulty product together with your purchase receipt should be returned to your retailer.

ONE (1) YEAR LIMITED WARRANTY Save This Warranty Information

EHS (International) Ltd. Guarantees this product free from defects in materials and workmanship for a period of one (1) year.

Should this unit be operated under conditions other than those recommended, at voltages other than the voltage indicated on the unit, or any attempts made to service or modify the unit, will render this **WARRANTY VOID**. The product you buy may sometimes differ slightly from illustration. This warranty is in addition to, and does not affect, your statutory rights

Should you have a problem with this product, please call our Help Desk on: (0870) 742 5021.

This product has been manufactured to comply with EEC Directives 2006/95/EG and 89/336/EEC

Waste electrical products should not be disposed of with household waste. Please recycle where facilities exist. Check with your Local Authority or retailer for recycling advice.



EHS, Manchester, M17 1RN

EHS 05/08

